



3 Ferns Mead , Farnham, GU9 7XP

A 2 double bedroom staggered terrace house situated on a cul de sac close to Farnham town. The property has a conservatory, rear garden, single garage and parking. No onward chain

£400,000

3 Ferns Mead

, Farnham, GU9 7XP



- Entrance hall
- Sitting/dining room
- Shower room
- Close to Farnham town
- Cloakroom
- Conservatory
- Garage and parking space
- Kitchen
- 2 double bedrooms
- Garden



[Directions](#)



Floor Plan

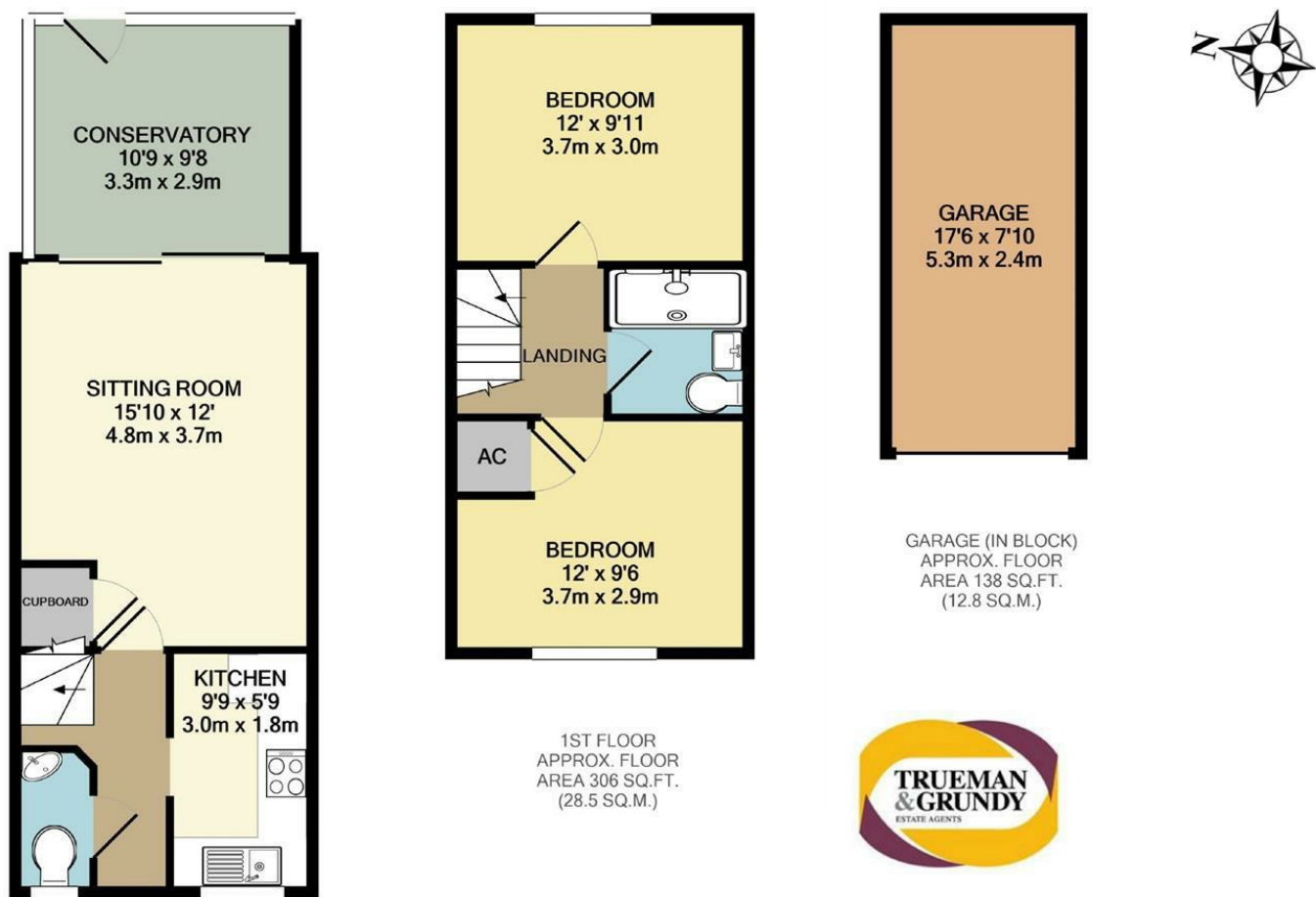

TOTAL APPROX. FLOOR AREA 855 SQ.FT. (79.4 SQ.M.)

Whilst every attempt has been made to ensure the accuracy of the floor plan contained here, measurements of doors, windows, rooms and any other items are approximate and no responsibility is taken for any error, omission, or mis-statement. This plan is for illustrative purposes only and should be used as such by any prospective purchaser. The services, systems and appliances shown have not been tested and no guarantee as to their operability or efficiency can be given

Made with Metropix ©2021

These particulars, whilst believed to be accurate are set out as a general outline only for guidance and do not constitute any part of an offer or contract. Intending purchasers should not rely on them as statements of representation of fact, but must satisfy themselves by inspection or otherwise as to their accuracy. No person in this firms employment has the authority to make or give any representation or warranty in respect of the property.

